



WATER TOWER MANUAL





Congratulations on purchasing a Valew Family of Companies quality water tower. Your tower was designed with the highest quality materials and equipment. Many of the manufacturer warranties exceed Valew Family of Companies warranty.

Included in this owner's manual are all of the manufacturer installation, operation and maintenance instructions. This will help familiarize you with your new tower, and help to ensure a long work life.

Many components on your new tower require periodic maintainance such as inspection and adjustments. It is our desire that your new water tower will provide you with years of trouble-free service.

Thank you

Valew Family of Companies

California
12522 Violet Road
Adelanto, California 92301

Texas
4688 State Hwy. 16 S
Graham, Texas 76450

844-208-2539
sales@valew.com
www.valew.com

WATER TOWER INSTRUCTIONS

1. Tank must be placed on one of the following:
 - A. Concrete: slab with the minimum 6" depth, level and free from severe vibration or major cracks
 - B. Soil: pad with level surface and compaction deemed appropriate by a soils engineer.
2. Never transport tank while tank is loaded.
3. Make sure that the portable hydraulic pump is stowed away in safe and secure place during transportation.
4. Re-torque wheel lugs before being properly trained and always tie off.
6. Remove loading sock before transporting.
7. Tank must be fully emptied before raising and lowering the tower.
8. Always operate one lever at a time, keeping tower level as possible, never exceeding 4" increments.
9. Never stand under tank unless all safety locks are in place.

To raise tower:

1. Place trailer on level surface as indicated above.
2. Remove trailer from truck
3. Connect hydraulic auxiliary motor.
4. Connect loading hoses to pipes before raising tower.
5. Connect discharge sock before raising tower.
6. Pull front and back lower pins.
7. Always operate one lever at a time.
8. lift left lever until front of tank raises a few inches, release lever.

To lower tower:

1. Connect hydraulic auxiliary motor.
2. Lift left lever until front pins are fully visible.
3. Lift right lever until rear pins are fully visible.
4. Remove lock pins.
5. Once lock pins are removed, do not walk under tower.

WATER TOWER INSTRUCTIONS

To lower tower cont

6. Press levers down one time at a time, lowering tank in small level increments until tank is fully lowered.
7. Install lower pins and safety clip.
8. Remove pump and all hoses. Securely stow prior to shipping

COMMON PARTS FOR VALEW WATER TOWER

1. Water tower engine and pump assembly- - - - -Part # 400101
2. VALEW water tower safety pin - - - - -Part # 400110
3. VALEW water tower "OFF" handle- - - - -Part # 400109
4. VALEW water tower "ON" handle - - - - -Part # 400108
5. 12" water tower fill hose - - - - -Part # 400107
6. Water tower 10" butterfly valve- - - - -Part # 400106
7. Water tower float rod assembly- - - - -Part # 400105
8. Water tower ss float ball- - - - -Part # 400104
9. Water tower float control- - - - -Part # 400103
10. 5.5 Honda engine- - - - -Part # 400102
11. Water tower hydraulic spool valve - - - - -Part # 400111
12. 3" CLA valve- - - - -Part # 100619
13. CLA valve diaphragm - - - - -Part # 103150
14. Water tower pump- - - - -Part # 400112
15. CLA valve spring - - - - -Part # 100622

For more parts please visit **parts.valew.com**
or give us a call at 844.208.2539

CF1-C1

Float Control

OPERATION

FLOAT POSITION	PORT 1	PORT 2
Up	Pressure	To Drain
Down	To Drain	Pressure

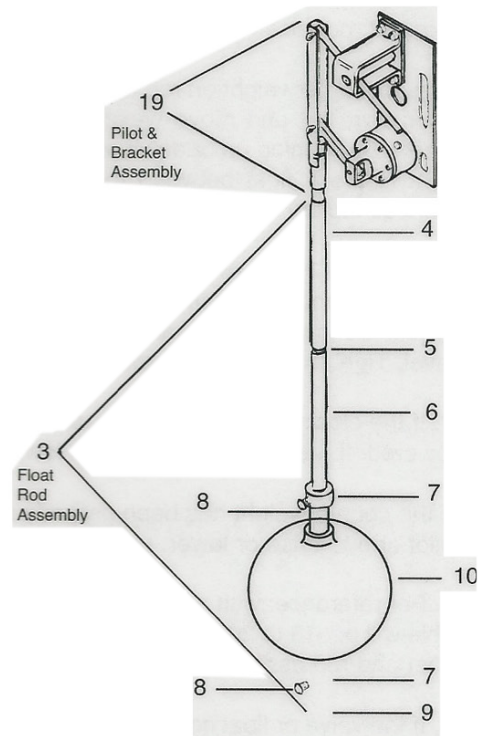
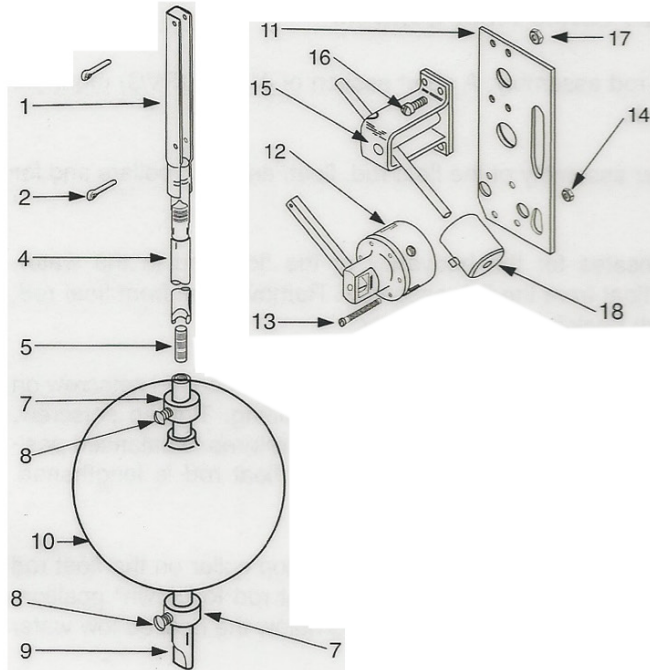

ITEM	DESCRIPTION	PART No.
1	Link Assembly, BRS	V8316B
2	Cotter Pins (2 required)	20175227D
3	Float Rod Assembly (2 ft.) (Item No. 4 thru 9), PVC	8829902K
4	Upper Float Rod (1 ft.), PVC	88298F
	Upper Float Road (2 ft.) PVC	Consult Factory
5	Stud (Required for connecting upper and lower rods and on for each extension rod), BRS	88264H
6	Extension Float Rod (1 ft.), PVC	88297H
	Extension Float Rod (2 ft.), PVC	Consult Factory
7	Stop Collar (2 required), PVC	38097C
8	Set Screw (1 for ea Stop Collar), SS	6798837J
9	Lower Float Rod (1 ft.)	88292J
	Lower Float Rod (2 ft.)	Consult Factory
10	Float Ball Stainless Steel (Standard)	C0648A
10	Float Ball, Plastic (Optional) Consult Factory	C9253A
11	Base and Mounting Plate (316)	V6369A
12	Pilot Valve Assembly CF1-C1	10529G
13	Machine Screw 6/32 x 1-1/2" (6 req'd)	6757530J
14	Hex Nut 6/32 (6 req'd)	678206K
15	Counter Balance Bracket Assembly, BRS	45569B
16	Machine Screw 10/32 x 9/16" (4 req'd)	6757822K
17	Hex Nut 10/32 (4 req'd)	6779506C
18	Counterweight (varies with rod length, includes set screw), Steel, Zinc Plated - Consult Factory	1-5' PVC Rod 20160501C
19	Pilot & Bracket Assembly CF1-C1, Std Material (Less Ball, Rod & Counterweight)	89016A

When ordering parts, please specify:

- All nameplate data
- Description
- Item Number

NOTE:

1. A stilling well (Min. 8" I.D.) must be provided around the float.

2. Inspect float and float assembly periodically.

PART NAME: CLAY_VALVE_BRKT

